

Recessed CE7035

# CE7035





## CE7035

### Basic Parameters

|             |                            |
|-------------|----------------------------|
| Application | Indoor                     |
| Material    | AL6063-T5,spraying surface |
| IP Grade    | IP20                       |
| Warranty    | 5 years                    |

### Electrical Parameters

### Optical Parameters

|                   |                          |
|-------------------|--------------------------|
| SDCM              | ≤3 Step(ANSI)            |
| Length            | 2400mm,Customized Length |
| Luminous Efficacy | 85LM/W                   |

### Dimensions

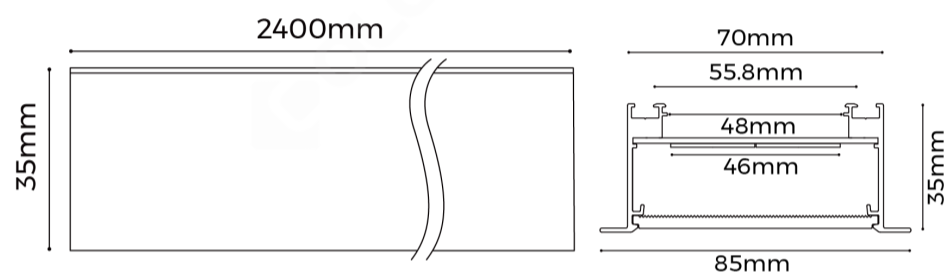

### Luminaire Parameters

| Version | Size(mm) | Power(W) | PCB Current(A) | CRI | CCT   | Lumens(LM) @White, Silver | Lumens(LM) @Black |
|---------|----------|----------|----------------|-----|-------|---------------------------|-------------------|
| Regular | 1000mm   | 29       | 12             | >80 | 4000K | 2448                      | 2080              |
| Regular | 1000mm   | 29       | 12             | >90 | 4000K | 2105                      | 1789              |

### Light Distribution

Regular-110°

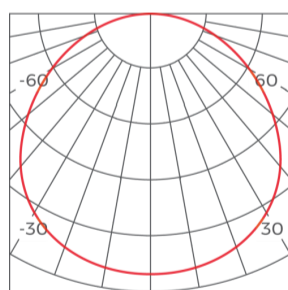

| h(m) | D(cm) | E(lx) |
|------|-------|-------|
| 1    | 285   | 847   |
| 2    | 571   | 204   |
| 3    | 856   | 87    |
| 4    | 1142  | 49    |

### Common Accessories

#### Splicing accessory

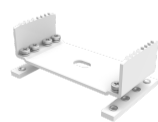

EX-E17

Applicable product model: CS7035/  
CE7035 Material process:SPCC/ Electroplating  
Size: L66.5\*W30\*H18mm  
Quantity: 1 PCS/SET Other:Includes  
mounting screws.

## Dedicated light source



### DM51202423

Applicable product model: CS5035/CS5070/CE5035(stick a single strip)  
 CS7035/CS7070/CE7035(paste two strips placed parallel to each other)  
 Size: 4000\*23\*1.5mm/5000\*23\*1.5mm  
 Cutting Unit:50mm  
 Input Voltage:DC24V  
 Typ.Power:14.4W/M(5M/roll); 24W/M(4M/roll)  
 Typ.luminous flux:  
 800LM/M@RGBNW(5M/roll)  
 1320LM/M@RGBNW(4M/roll)  
 CCT:RGB(DMX)+2700/RGB(DMX)+3000/RGB(DMX)+4000/RGB(DMX)+6000K  
 CRI: RA80 @ white light  
 Other:20# wire diameter,outer diameter 5.5mm, PVC material;5PIN red/black/green/blue/white wire



### DS81602423

Applicable product model: CS5035/CS5070/CE5035(stick a single strip)  
 CS7035/CS7070/CE7035(paste two strips placed parallel to each other)  
 Size: 4000\*23\*1.5mm/5000\*23\*1.5mm  
 Cutting Unit:50mm  
 Input Voltage:DC24V  
 Typ.Power:14.4W/M(5M/roll); 24W/M(4M/roll)  
 Typ.luminous flux:  
 2300LM/M@RA80,4000k(5M/roll)  
 3600LM/M@RA80,4000k(4M/roll)  
 CCT: 2700/3000/3500/4000/5000/6500K  
 CRI: 80/90  
 Other:18# wire diameter,PVC material, 2PIN red-black wire



### DS83202423

Applicable product model:CS5035/CS5070/CE5035(stick a single strip)  
 CS7035/CS7070/CE7035(paste two strips placed parallel to each other)  
 Size: 3000\*23\*1.5mm/4000\*23\*1.5mm  
 Cutting Unit:50mm/16LEDs  
 Input Voltage:DC24V  
 Typ.Power:  
 48W/M(2700K+6500K)@3M/roll  
 28.8W/M(2700K+6500K)@4M/roll  
 Typ.luminous flux:  
 4000LM/M@RA80,2700K+6500K(4M/roll)  
 6700LM/M@RA80,2700K+6500K(3M/roll)  
 CCT: 2700K+6500K  
 CRI: 80/90  
 Other:Outer diameter 6mm,18# wire diameter, brown-blue-green 3PIN crystal wire

## Cover



### CV-CS7035D

Applicable product model:CS7035/CS7070/CE7035(suitable for down-lighting)  
 Diffuser Nature: Diffuser  
 Material process: Silica gel flexible/smooth  
 Light transmittance:≥65%  
 Size: 20000\*67.2\*5mm  
 Other: Fire protection rating UL94-V2 ;

## Controller



### CR2-GBA

Product Name: CR2-GBA Input Voltage: 12-48V Output Current:8A\*2CH,Max 16A Output Power:192W/384W@12V/24V , 384W/576W@36V/48V Dimming Mode: Two-color 2.4 remote control IP:IP20 Product Size:L175\*W45\*H27(mm)

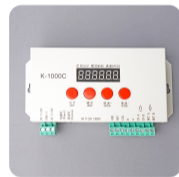

### K-1000C

Product Name: K-1000C Input voltage: 5-24V Control Pixel Points:Point Control 1CH\*1024(SPI),Point Control 1CH\*512(DMX) Dimming mode: DMX/SPI control IP:IP20Warranty: 5 years



### K-8000C

Product Name: K-8000C Input Voltage: 5-24V Control Pixel Points:Point Control 8CH\*1024(SPI),Point Control 8CH\*512(DMX) Dimming mode:DMX/SPI control IP:IP20Warranty: 5 years

## End cap accessory



### EC-ME7035

Applicable product model: ME7035  
 Material process: aluminum/ powder spraying Size: L85\*W35\*H2.5mm Quantity:2PCS/ set

## Installation accessory



### CP-55

Applicable product model: MS7035/MS7070/ME7035 Applicable installation: Pendant/Ceiling/Recessed Material process: Stainless Steel Size: L57.87\*W20\*H5.4mm Quantity: 4 PCS/SET



### RB-04

Applicable product model: ME3535/ME5035/ME7035 Installation method: Recessed Material process: aluminum alloy/oil spray Size: 24\*6.9\*15.7mm Quantity: 4PCS/ set

## CCT-Remote control



### R7-1

Product Name:R7-1 Dual Color Remote Working Voltage : 3VDC (Battery CR2032 Operating Frequency:2.4GHz Remote Control Distance: 30 meters Operating Temperature: -30°C~55°C Product Size: L107\*W58.5\*H9(mm)

**Power Supply**



**BK-DEV200-24V0D**  
 Applicable product model: General  
 Dimming mode: DALI2,PUSH-dimming,1-10V 3in1 dimming  
 Size: 361\*33.1\*22.8mm  
 Input voltage: AC200-240V  
 Operating frequency: 50/60Hz  
 PF value: ≥0.9  
 Output voltage: DC24V  
 Output current: ≤8.3A  
 Power: 200W  
 Efficiency: 0.92  
 Certification: TUV, CE, RCM  
 Case material: Metal housing



**BK-DGVX-24V0D**  
 ProductName: BK-DGV036-24V0D/BK-DGV060-24V0D/BK-DGV100-24V0D  
 Applicable product model: General  
 Output power: 36W/60W/100W  
 Output current: ≤1.5A/≤2.5A/≤4.2A  
 Product size: 245.0\*30.0\*21.0mm/285.0\*30.0\*21.0mm/355.0\*30.0\*21.0mm  
 Input voltage: AC200-240V  
 Operating frequency: 50/60Hz  
 Output voltage: DC24V  
 PF value: ≥0.9  
 Efficiency: ≥0.88  
 IP: IP20  
 Dimming mode: DALI-2,PUSH-Dimming,1-10V 3in1 Dimming  
 Certification: CE, ENEC, UKCA, RCM, CCC, EL  
 Material: Metal housing  
 Warranty: 5 years



**BK-MEV200-24V0M**  
 Applicable product model: General  
 Dimming mode: 1-10V Dimming  
 Size: 321.5\*48\*30mm  
 Input voltage: AC200-240V  
 Operating frequency: 50/60Hz  
 PF value: ≥0.9  
 Output voltage: DC24V  
 Output current: ≤8.3A  
 Power: 200W  
 Efficiency: 0.93  
 Certification: CE, ENEC, UKCA, RCM, CCC, EL  
 Case material: Metal housing



**BK-MGVX-24V0M**  
 ProductName: BK-MGV036-24V0M/BK-MGV060-24V0M/BK-MGV100-24V0M  
 Applicable product model: General  
 Output power: 36W/60W/100W  
 Output current: ≤1.5A/≤2.5A/≤4.2A  
 Product size: 245.0\*30.0\*21.0mm/285.0\*30.0\*21.0mm/355.0\*30.0\*21.0mm  
 Input voltage: AC200-240V  
 Operating frequency: 50/60Hz  
 Output voltage: DC24V  
 PF value: ≥0.9  
 Efficiency: ≥0.89  
 IP: IP20  
 Dimming mode: 1-10V Dimming  
 Certification: TUV, CE, ENEC, RCM  
 Material: Metal housing  
 Warranty: 5 years



**LF-GHYXH24**  
 Applicable product model: General  
 Dimming mode: Non-Dimming  
 Size: 316\*30.7\*22.8mm / 361\*33.1\*22.8mm  
 Input voltage: AC220-240V  
 Operating frequency: 50/60Hz  
 PF value: ≥0.9  
 Output voltage: DC24V  
 Output current: ≤4.25A / ≤10A  
 Power: 100W / 240W  
 Efficiency: 0.92  
 Certification: ENEC,CE,CB,RCM,UKCA,MM,CCC  
 Case material: Plastic

**Packing**

| QTY/CTN | N. WT (ctn) | G.WT (ctn) | Size (cm/carton) | Product Size (mm) |
|---------|-------------|------------|------------------|-------------------|
| 12      | 21.6        | 23.76      | 245*28.5*23.5    | 2400*70*35mm      |